

Illustrated **P**arts **B**reakdown

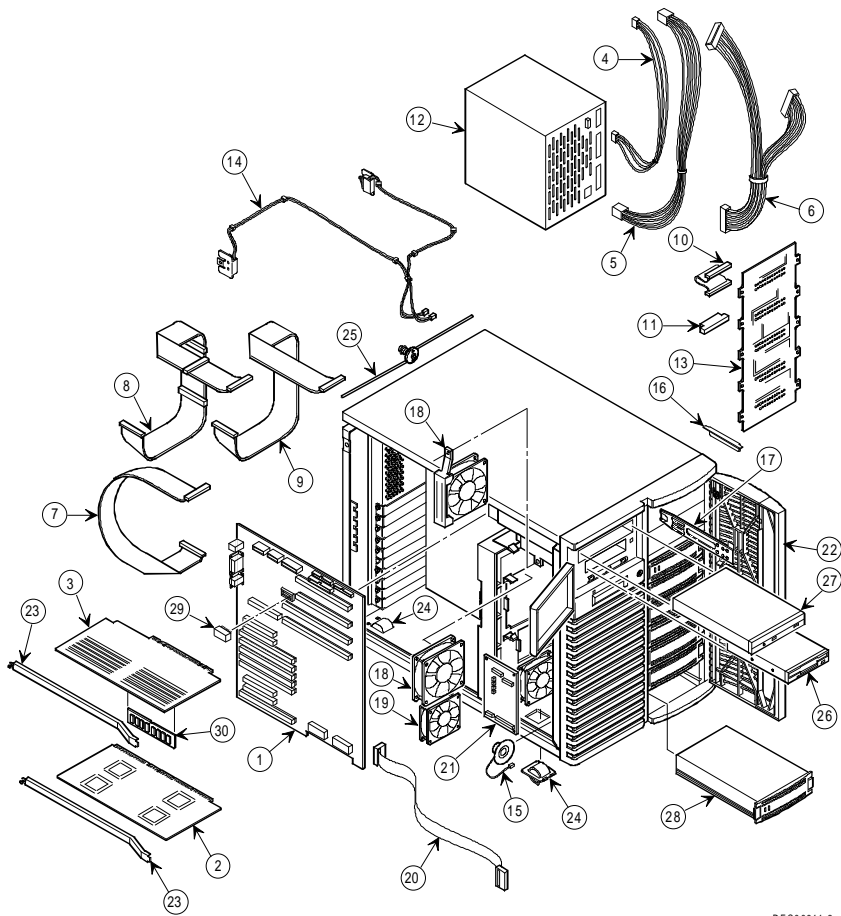

1

Illustrated Parts Breakdown



DEC00811-2

2

FRU List

Server

Figure Legend	FRU	Description
1	30-46686-01	Intel Xtended Xpress 15-inch baseboard
2	30-46685-01 30-46685-02	Intel Xtended Xpress cyclopc CPU board Intel Xtended Xpress twin peaks CPU board
3	30-46687-01	Intel Xtended Xpress fault tolerant memory board
4	70-31890-01 70-32451-01	Wire assembly, 3COND, 20AWG Wire assembly, 3COND, 26AWG, 178MM
5	70-31894-01	Wire assembly, 12COND, 20AWG
6	70-332452-01	Wire assembly, system power
7	17-03460-10 17-03460-11	Cable assembly, flat, 34-pin (for diskette drive)
8	17-04144-01	68-pin SCSI cable assembly (five connectors)
9	17-04143-01	68-pin SCSI cable assembly (two connectors unshielded)
10	17-04143-02	68-pin SCSI cable assembly (jumper cable)
11	12-45538-01	Wide SCSI terminator
12	30-43120-01	Power supply, 450 W
13	54-23384-01	Hot-swap backplane module
14	70-31909-01	Micro switch cable assembly

continued

FRU List

Figure Legend	FRU	Description
15	12-39309-01	Speaker assembly, 270 mm
16	70-30796-01	Cover assembly, 5.25-inch drive
17	74-48642-01	Side rail, right
	74-48642-02	Side rail, left
18	12-41569-02	120 x 120 mm fan assembly
	12-41569-04	
19	12-44211-01	92 x 92 mm fan assembly
20	17-04330-01	Cable assembly, flat, 20-pin (OCP power/data cable)
21	54-24530-01	Fan/power controller module
22	70-31906-01	Door assembly
23	70-32448-01	Retainer assembly
24	74-49201-01	Front CAM
25	12-43231-03	Keylock

Storage Devices

Figure Legend	FRU	Description
26	00-RX23L-AA	3.5-inch, floppy disk drive, 1.44 MB
	00-RX26L-E0	3.5-inch, floppy disk drive, 2.88 MB
	00-RX33L-AA	5.25-inch, floppy disk drive, 1.2 MB
27	30-45370-01	5.25-inch, half-height quad speed SCSI CD-ROM
28	00-RZ25L-LC	3.5-inch, SCSI disk drive, 535 MB
	00-RZ26L	3.5-inch, SCSI disk drive, 1.0 GB
	00-RZ28E	3.5-inch, SCSI disk drive, 2.1 GB

FRU List

Memory

Figure Legend	FRU	Description
29	21-39151-01	Real-time clock (server battery)
30	54-21225-BA	16 MB SIMM (4 x 4)
	54-21277-AA	32 MB SIMM (4 x 8)
	54-23170-AA	64 MB SIMM (4 x 16)
	54-23623-DA	128 MB SIMM (4 x 32)

Server Components (Not Illustrated)

FRU	Description
74-49277-01	Push button
54-24528-01	OCP module
74-49365-01	Drive holder
70-31674-03	Enclosure assembly
70-31901-03	Enclosure subassembly
30-43447-02	LCD,DV16100 S2FTLY
12-41768-02	SCSI terminator

FRU List

Packaging, Labels, and Nameplates

FRU	Description
74-49386-21	Nameplate, Prioris ZX 5133MP
74-49386-22	Nameplate, Prioris ZX 5133MP/2
74-49386-23	Nameplate, Prioris ZX 5133MP/4
74-49386-24	Nameplate, Prioris ZX 5166MP
74-49386-25	Nameplate, Prioris ZX 5133MP/2
74-49386-26	Nameplate, Prioris ZX 5133MP/4
74-49386-27	Nameplate, Prioris ZX 5133MP/3
74-49386-28	Nameplate, Prioris ZX 5166MP/3

Miscellaneous

FRU	Description
17-04009-01	SCSI adapter cable assembly (68- to 50-pin)
17-04009-02	SCSI adapter cable assembly (68- to 50-pin)
54-22469-01	DEC PCI ethernet 1-channel, three connector
54-22477-01	DEC EISA ethernet 1-channel, three connector
30-42752-01	3 COMM ethernet III EISA BNC NIC
30-42753-01	3 COMM ethernet III EISA TP NIC
30-42584-01	Proteon EISA token ring NIC
00-KZESC-XA	Digital 1-channel EISA RAID adapter
30-41854-01	14.4 bps data/fax modem
30-42291-01	28.8 data/14.4 fax modem
PC7XS-AA	PS/2 2-button mouse
QB-2XHAH-SA	STGWK EBR Intel RX23/Lic Pkg