

EM-9341

3.5" Intel® Celeron® M EBC with VGA, LVDS, Audio/ PCOM/ USB/ DIO and PCI/104 expansion

- VGA
- LVDS
- AUDIO
- LAN
- CF
- PCOM
- USB
- DIO
- PCI/104

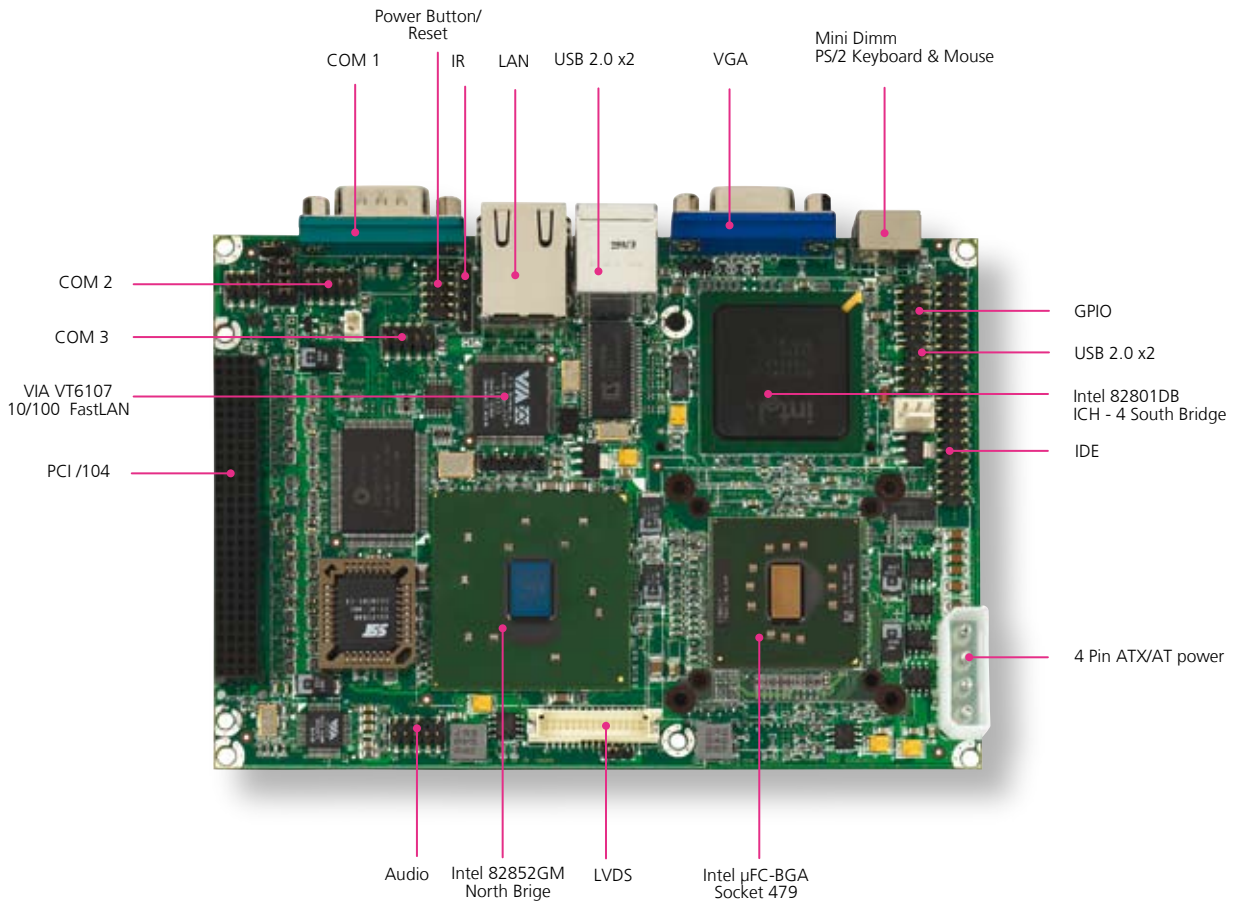

FEATURES

- Onboard ULV Intel Celeron M
- Intel 852GM + ICH4 chipset
- Dual-channel 36bit LVDS, VGA
- 6.0 channel audio, onboard header
- 10/100/1000 LAN with PXE support
- USB, DIO, CF, Power COM
- PCI/104 expansion slot

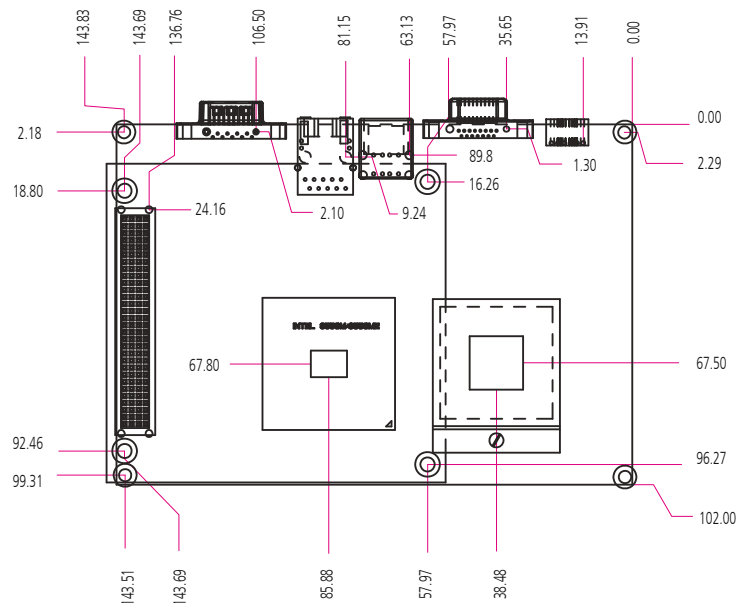

FEATURE	DESCRIPTION		
Platform	Form Factor	3.5" EBC	
	Processor	uFC-BGA Intel Celeron M ULV Processor	
	Chipset	Intel 82852GM + ICH4	
	BIOS	AMI Flash BIOS	
	Cache Memory	512KB (CPU integrated)	
System Memory	Technology	DDR 200/266	
	Max Capacity	1GB	
	Socket	200-pin SO-DIMM x 1	
OS Support	Windows XP, Win CE, Linux		
Storage Interface	IDE Interface	44-pin header x 1	
	CompactFlash	CF slot x 1	
	Speed	10/100/1000 Mbps	
Networking	I/O	RJ-45 x 1	
	Controller	VIA VT 6122, Support PXE LAN boot	
Display	Controller	Intel 82852GM integrated graphics	
	Shared memory	Intel DVM up to 64MB	
	Output	VGA x 1, Dual 36 bit LVDS	
Audio	Codec	VIA VT1618 with AC97 codec	
	I/O	pin header (Line-in, line-out, mic)	
	Serial Port	RS-232 x 2, RS-232/422/485 x 1, (COM2 supports +5/12V, by jumper)	
	Universal Serial Bus	4 USB 2.0 (2 via onboard header)	
	Digital IO	TTL input x 4, TTL output x 4	
	IR Interface	1	
	Keyboard	Mini-Din PS/2	
	Mouse	Mini-Din PS/2	
	Hardware Monitoring	Monitor	Voltage and temperature
		RTC	integrated in chipset
Watchdog timer		256 level software programmable	
Cooling	Heatsink		
Expansion	PCI/104 x 1		
Environmental Parameters	Temperature, ambient operating	0~60°C (32~122°F)	
	Humidity (RH), ambient operating	0~90%, non-condensing	
	Storage Temperature	-20-70°C (-4-158°F)	
Physical Dimensions	Dimensions	146 x 102mm (5.7" x 4")	
Power	Input	+5V and +12V	
	Form Factor	4-pin ATX/AT	
Compliance	CE, FCC, RoHS		

ORDERING INFORMATION

EM-9341A	Intel® ULV Celeron® M 600 MHz (512K cache) onboard w/3 x COM/VGA/LVDS/CF/GbE LAN
EM-9341B	Intel® ULV Celeron® M 1G MHz (0 cache) onboard w/3 x COM/VGA/LVDS/CF/GbE LAN

PLATFORM ARCHITECTURE

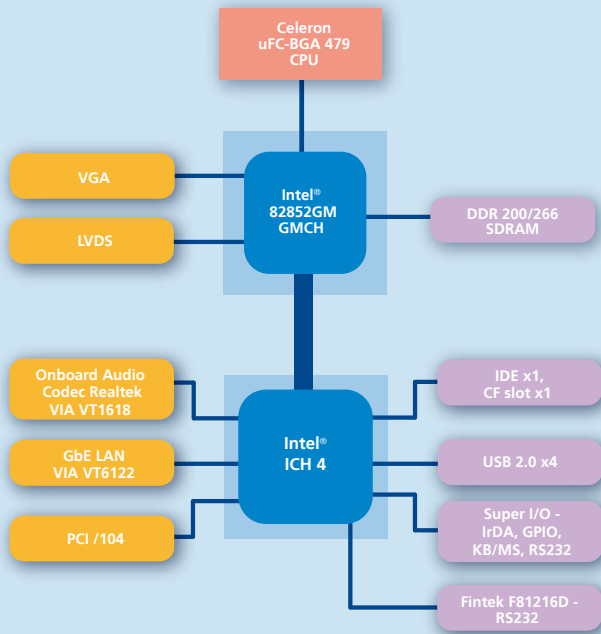

About Lanner

Founded in 1986 and publicly listed (TAIEX 6245) since 2003, Lanner Electronics Inc. is an ISO 9001 certified designer and manufacturer of reliable, frontline security, storage and applied computing platforms and solutions. With headquarters in Taipei, Taiwan and branches in the U.S., India, and China, Lanner is uniquely positioned to deliver custom technical solutions with localized, value-added service.

Contact information

Lanner Electronics Inc
7F, 173, Section 2 Datong road
Sijhih City, Taipei County 221, Taiwan

T +886 2 86926060

F +886 2 86926101

E sales@lannerinc.com

W www.lannerinc.com