

# EVEREX SYSTEMS, INC. TEMPO LX (NOTEBOOK)

<b>Processor</b>	80386SX
<b>Processor Speed</b>	16/20/25MHZ
<b>Chip Set</b>	C & T
<b>Max. Onboard DRAM</b>	5MB
<b>Cache</b>	None
<b>BIOS</b>	Phoenix
<b>Dimensions</b>	355mm x 304mm
<b>I/O Options</b>	Floppy drive interface, IDE interface, modem card, parallel port, serial port, VGA port
<b>NPU Options</b>	80387SX

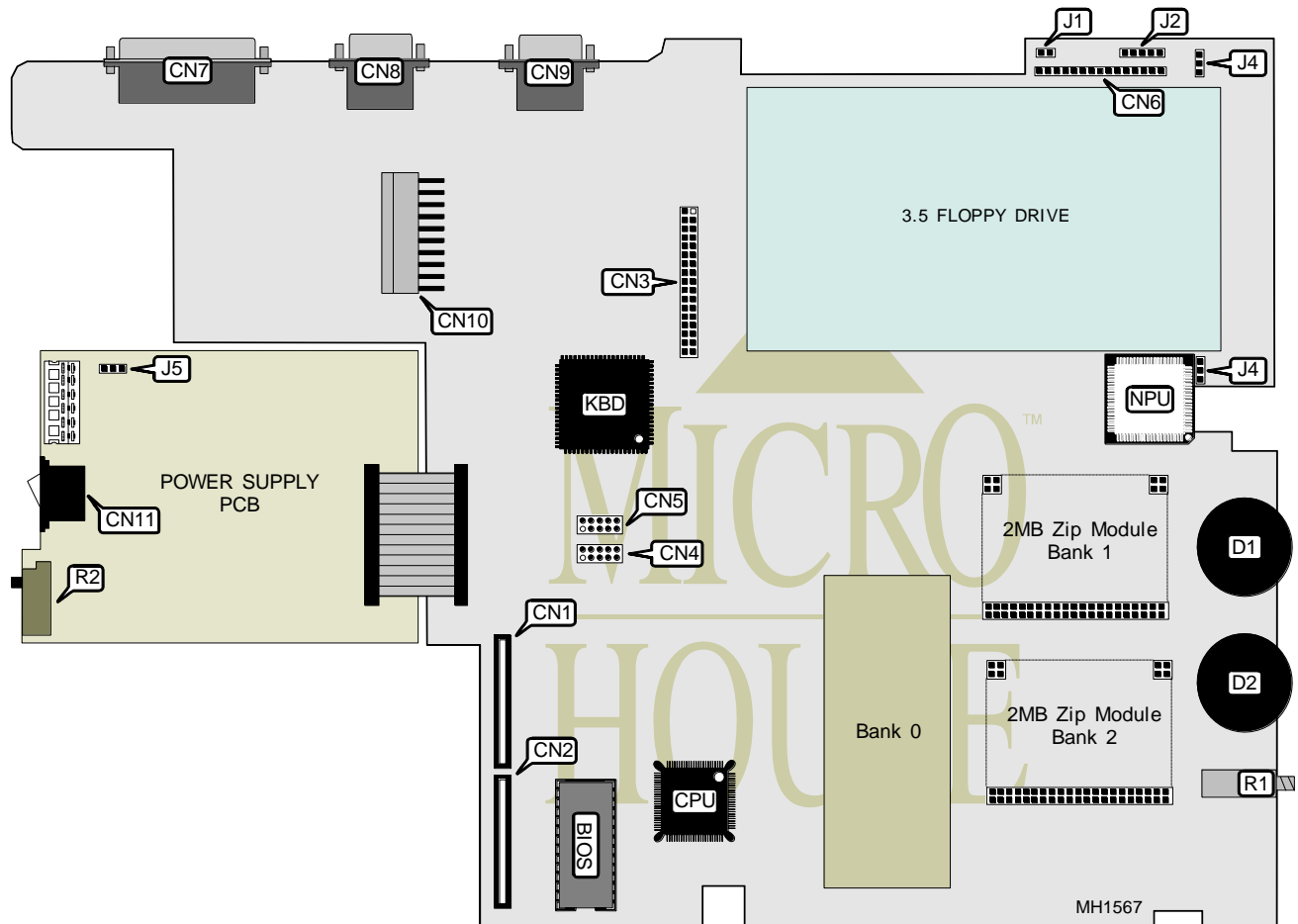

CONNECTIONS			
Purpose	Location	Purpose	Location
IDE interface	CN1 & CN2	Modem (COM2)	CN10
Floppy drive interface	CN3	Power switch	CN11
Keyboard connector	CN4 & CN5	Contrast dial	D1
LCD display	CN6	Brightness dial	D2
Parallel port	CN7	Reset switch	R1
Serial port (COM1)	CN8	Circuit breaker reset switch	R2
VGA port	CN9		



**EVEREX SYSTEMS, INC.**  
**TEMPO LX (NOTEBOOK)**

... continued from previous page

USER CONFIGURABLE SETTINGS		
Function	Jumper	Position
í Factory configured - do not alter	J1	N/A
í Factory configured - do not alter	J2	N/A
í Factory configured - do not alter	J3	N/A
í Factory configured - do not alter	J4	N/A
í Factory configured - do not alter	J5	N/A

DRAM CONFIGURATION			
Size	Bank 0	Bank 1	Bank 2
1MB	1MB	1MB	1MB
3MB	NONE	2MB ZIP Module	2MB ZIP Module
5MB	NONE	NONE	2MB ZIP Module

Note: 1MB DRAM is soldered to the system board, 2MB ZIP modules can be installed the additional memory will be detected via the system BIOS.

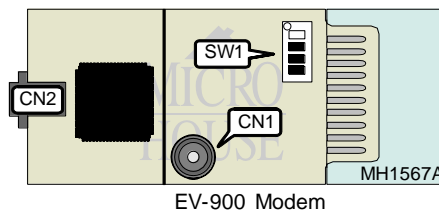

CONNECTIONS			
Purpose	Location	Purpose	Location
Speaker	CN1	RJ11	CN2

MODEM CONFIGURATION			
Function	SW1/switch 1	SW1/switch 3	SW1/switch 4
MNP enabled	On	On	On
MNP disabled	Off	On	On
Normal	On	On	On
Self test	On	Off	On
Relay test	On	On	Off

Note: Switch #2 is factory configured and should not be altered.